

SULKY®

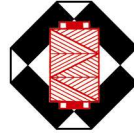

"BLOCK OF THE MONTH"

NOVEMBER



BOM 11

At Home, Christmas tree

Technique

Sewing by numbers on Paper Solvy and stencils

Pattern

House and Christmas tree

At Home

Row 5, block 3

Finished block size: 12 x 12 inch

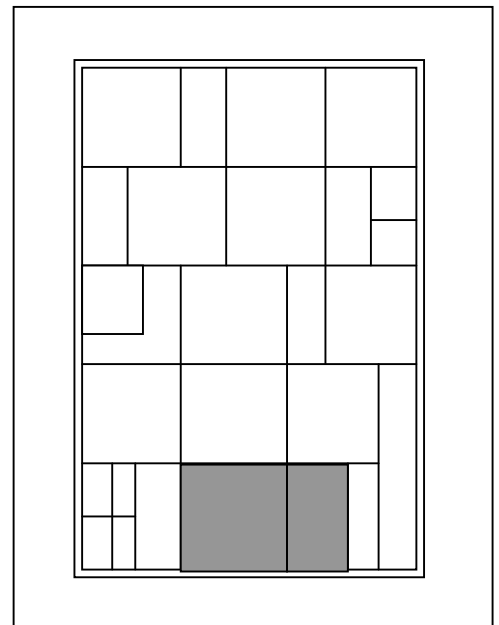

Block size with seam margin: 12 ½ x 12 ½ inch

Christmas tree

Row 5, block 4

Finished block size: 8 x 8 inch

Block size with seam margin: 6 ½ x 6 ½ inch

Materials used

At Home

Blue 3

Brown 1 and 4

Rust 1

Beige 5 and 8

Red 4 and 5

Green 9 and 10

Christmas tree

Beige 8 as border

Material remnants in beige 1, 3, 4, 5, 7 and 9

Green 3, 4, 6, 7, 9, 10 and 12

Instructions

Sewing the “At Home” block

1st Step

Enlarge the pattern from A4 to A3 and transfer onto Paper Solvy.

2nd Step

Finish the individual segments using the “Sewing by Numbers” method.

Segment A / B side parts of house with window

Segment C front door with step

Segment D 2 x top side parts of house

Segment E middle part of house with porch

Segment F roof with background

Segment G chimneys with background

3rd Step

Sew A and B onto C.

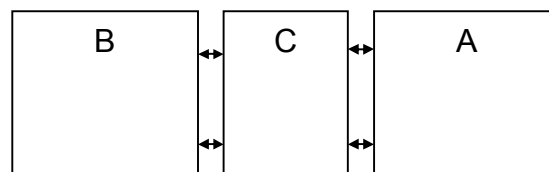

4th Step

Sew the Ds onto E.

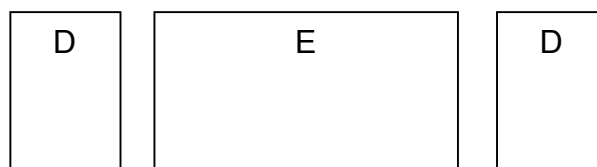

5th Step

Sew F onto G.

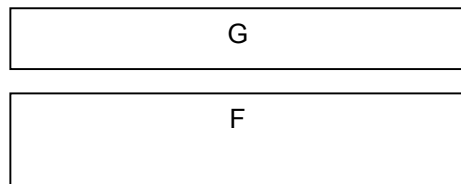

6th Step

Join together the finished parts A, B, C and D, E, D.
Then sew on parts F and G.

7th Step

Check the size of the blocks and if necessary cut
to 12 1/2 x 12 1/2 inch.

Instructions

Sewing the Christmas tree

1st Step

Enlarge the pattern from A4 to A3 and transfer onto Paper Solvy.

2nd Step

Finish the individual segments using the "Sewing by Numbers" method.

Segment A, B, C, D Christmas tree

Segment E trunk with background

3rd Step

Cut F and G as a stencil

4th Step

Sew A, B, C and D together



Sew F + G left and right



Sew E

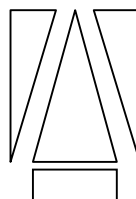

5th Step

Check the size of the blocks and if necessary cut
to 8 1/2 x 12 1/2 inc

Pattern

At Home

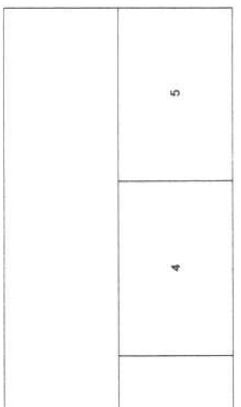
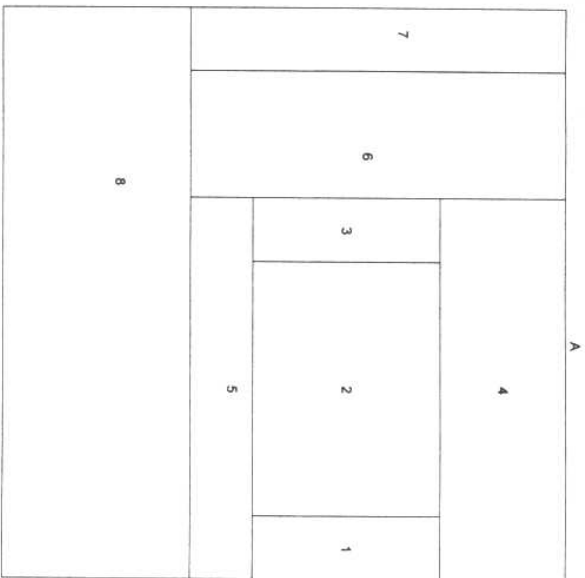
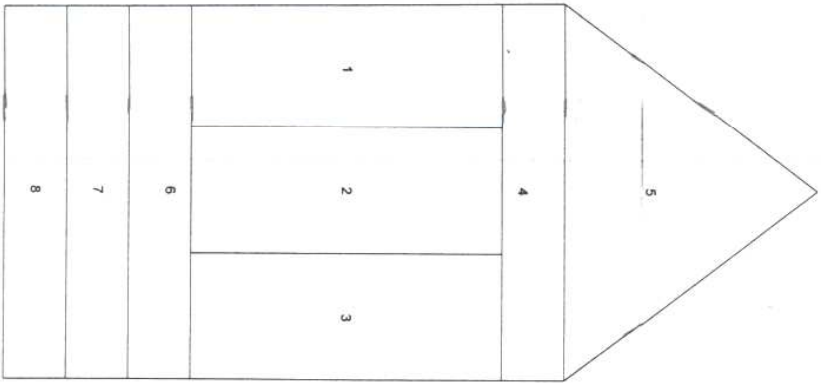
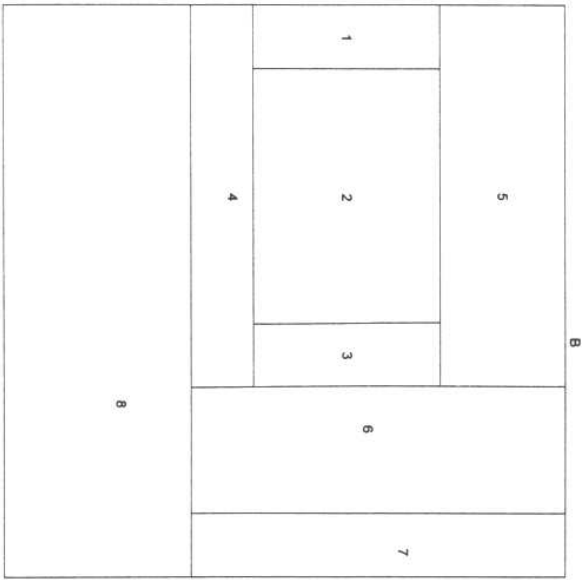

**Pattern
Christmas tree**

